

LUXNEON™

SIDE BEND

Indoor/Outdoor Series

COLORFUL CURVES

Designed for today's modern architectural and signage applications, **LUXNEON™ LED RGB Flexible Side Bending Neon Tube Lighting** is a bendable, flexible, cuttable solution that can contour to your curved architectural spaces and applications. Simply plug it in and watch the lighting magic happen right before your eyes. With LUXNEON RGB, introduce dazzling color changes to your cove and embedded architectural lighting applications. This lighting solution is sure to create drama and enliven your space!

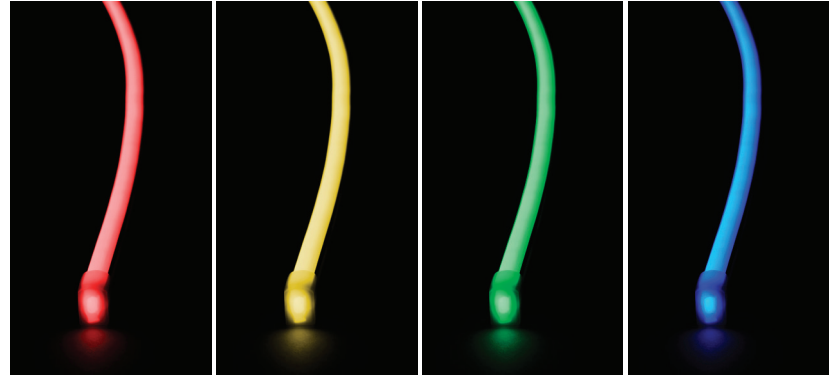

Create a colorful, continuous line of light for curved spaces with LUXNEON™!

KEY FEATURES

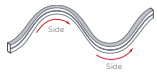
**BEND & FLEX
SIDEWAYS**

RGB COLOR

**IP67 RATED DUST
& TEMPORARY
IMMERSION SAFE**

WIDE BEAM ANGLE

**V-2 FLAME
RETARDANT
(UL94)**

FIELD CUTTABLE
NEON
**HOTSPOT-FREE,
NEON-LIKE
ILLUMINATION**

UV SAFE

**EASY TO
INSTALL**

PLUG & PLAY

**LONG LED
LIFESPAN**

ASSURED QUALITY

E477011

100% QC

**LIMITED
WARRANTY**

PROJECT NAME/NO.	PART NUMBER
SPECIFIED BY	NOTE

LUXNEON™

SIDE BEND

Indoor/Outdoor Series

MECHANICAL

PARAMETERS

LED Count 36 pc/ft (118 pc/m)

LED Roll Length 32 ft ¹³/₁₆" (10m) or built to order

Tube Dimensions Tube cross-section: 0.67" (17mm) x 0.39" (10mm) •
Tube w/end cap: 0.75" (19mm) x 0.47" (12mm)

Flat Bend 1.18" (30mm)

Bend Type Lateral flat bend

Cutting Length 2.28" (58mm)

CONSTRUCTION & BASE MATERIAL

Tube Material Silicone

Tube Max. Run Length may be customized for your order

PCB Material Flexible PVC with SMD LEDs

End Cap Material Silicone

Diffuser Material Silicone

Substrate Material Silicone

Mounting Clip Material Plastic

Mounting Channel Material Aluminum

Flammability Rated UL94 V-2 flame retardant

COMPLIANCE & REGULATORY APPROVAL

UL E477011 • cUL E477011 • RoHS • CE • Lead Free • Warranty 5 years

COLORS

Diffuser Milky white silicone

Standard White Silicone Tubing Stardust gray

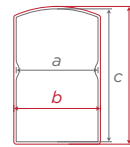
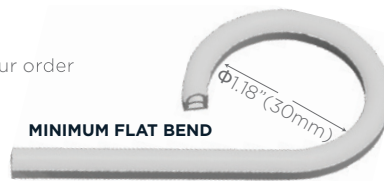

CROSS-SECTION

a Profile width	0.39" (10mm)
b End cap width	0.47" (12mm)
c Profile height	0.67" (17mm)
d End cap height	0.75" (19mm)

TUBE CUTTING DIAGRAM & DIMENSIONS

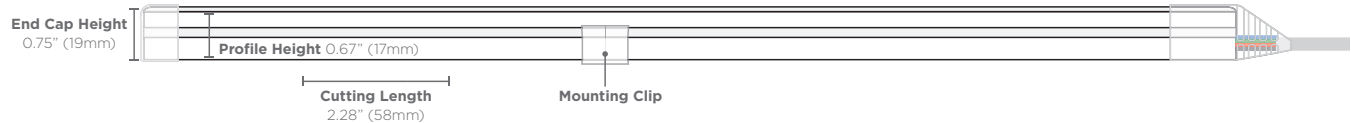

LED TYPE	OPERATING VOLTAGE	FLAT BEND minimum	DIMENSIONS tube cross-section	CUTTING LENGTH	# LEDS per cut section
RGB NEON TUBE	24V	1.18" 30mm	0.67" x 0.39" 17mm x 10mm	2.28" 58mm	6

MOUNTING CLIP DIMENSIONS

DIMENSIONS	RADIUS
0.27" x 0.44" x 0.47" 6.8mm x 11.1mm x 12.0mm	0.07" 1.8mm

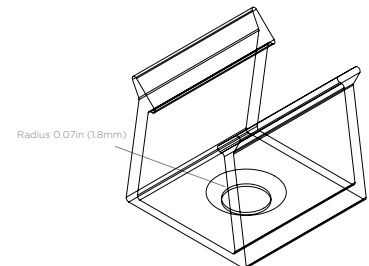
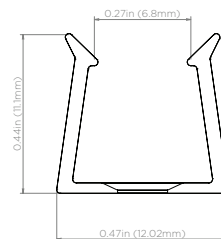
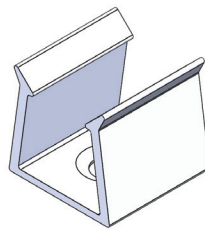

PROJECT NAME/NO.	PART NUMBER
SPECIFIED BY	NOTE

LUXNEON™

SIDE BEND

Indoor/Outdoor Series

ELECTRICAL

PHOTOMETRICS

Wide Beam Angle 120°

Lamp Life 60,000+ hours

Color Temperatures Red (617nm) • Green (515nm) • Blue (462nm)

Lumen Output Red 17.9 lm/ft (58.8 lm/m) • Green 35.3 lm/ft (115.9 lm/m) • Blue 6.9 lm/ft (22.5 lm/m) • RGB 60.1 lm/ft (197.2 lm/m)

DIMMING

- Pulse-width modulation dimming (PWM)
- DMX/DALI
- Radio Frequency (RF) Remote control

POWER SUPPLY

Input Voltage 24VDC constant voltage

Input Current 0.22 A/ft (0.72 A/m)

Power Consumption 5.3 W/ft (17.3 W/m)



Wire Size 20 AWG 2 Wire

Please Use Only with Class 2 Power Supply

Max. No. of Wire Connections 2

Connector Type Hardwire

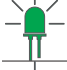
PHOTOMETRIC DATA TABLE

	CCT	EFFICACY	BEAM ANGLE	LUMINOUS FLUX	POWER
	Red 617nm	12.79 lm/W	120°	17.9 lm/ft 58.8 lm/m	5.3 W/ft 17.3 W/m
	Green 515nm	21.11 lm/W		35.3 lm/ft 115.9 lm/m	
	Blue 462nm	4.04 lm/W		6.9 lm/ft 22.5 lm/m	
	RGB	11.41 lm/W		60.1 lm/ft 197.2 lm/m	

MAX. LOAD & MAX LENGTH

MAX LOAD 96 W	
# Power Supplies	Max. Tube Length
1	18 ft (5.5m)

LUMINOUS INTENSITY DISTRIBUTION DIAGRAM

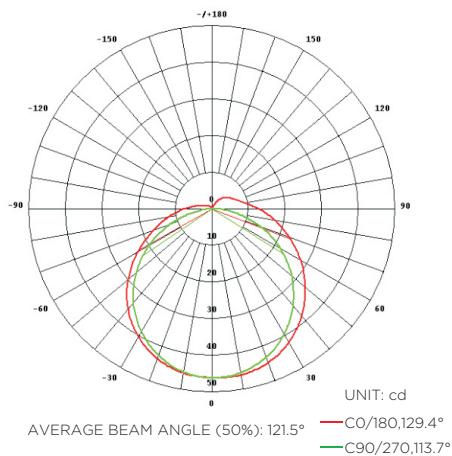

AVERAGE ILLUMINATION

Luminous Flux: 102.3lm		
Height	Eavg, Emax	Diameter
1cm	137343,462247 lx	3.04cm
2cm	34336,115562 lx	6.08cm
3cm	15260,51361 lx	9.13cm
4cm	8584,28890 lx	12.17cm
5cm	5494,18490 lx	15.21cm
6cm	3815,12840 lx	18.25cm
7cm	2803,9434 lx	21.29cm
8cm	2146,7223 lx	24.34cm
9cm	1696,5707 lx	27.38cm
10cm	1373,4622 lx	30.42cm
Beam Angle: 113.35°		

PROJECT NAME/NO.

PART NUMBER

SPECIFIED BY

NOTE

LUXNEON™

SIDE BEND

Indoor/Outdoor Series

INSTALLATION

Field Cuttable LUXNEON RGB is fully field cuttable every 2.28" (58mm). As seen in the installation guide, use a knife or recommended cutting tool.

Field Bendable LUXNEON RGB is field bendable and may be laterally flexed or curved to fit your retail or architectural environment to create unique profiles, contours, and patterns. **LUXNEON RGB is designed for lateral (left to right) side bending only.** Do not bend LUXNEON RGB against its natural curvature, which will cause the internal LED light engine to snap and render it unusable.

Environment Indoor and outdoor location safe. Light colors will retain their hue in daylight even over extended periods of time when installed outdoors. Tubes are UV safe, hydrocarbon insensitive, and resistant to fading.

IP67 Waterproof LUXNEON RGB is fully IP67 compliant. Tubes are protected from total dust ingress and are temporary immersion safe.

Operating Temperature -13°F ~ +140°F (-25°C ~ +60°C)

Ambient Temperature -13°F ~ +158°F (-25°C ~ +70°C)

Heat Sink Not required for installation. LUXNEON RGB illuminates spaces with reduced thermal consumption and output.

Mounting May be mounted with mounting clips or with a mounting channel. Mounting clips and channels must be secured onto a surface with screws before the LUXNEON RGB product may be pushed into it to complete the installation. Mounting clips are ideal for indirect lighting applications. For direct lighting applications, the mounting channel is recommended. Mounting channels are also designed to help prevent the light engine from sagging when used for under shelf and cabinet applications.

Connecting Multiple Tubes LUXNEON RGB may be requested custom cut to your desired length or cut into smaller segments and connected with an interconnection connector to chain the tubes together. Keep in mind the max load restrictions enforced by Class 2 regulations when determining the number of power supplies needed for your tube. In compliance with Class 2, LUXNEON RGB lighting solutions that are fully customized by LEDCONN may be mounted side by side if extra length is required beyond the max compliant length of 18ft (5.5m). Applications requiring longer lengths than 18ft (5.5m) will require higher capacity drivers with multiple parallel connections between driver and LUXNEON or individual drivers for each 18ft(5.5) run.

SAFETY DISCLOSURES

Electric Code Compliance Please make sure to install LUXNEON RGB in accordance with standard national and local electrical codes.

Outdoor Usage LUXNEON RGB is suitable for indoor and outdoor location applications. For wet location installations, please make sure to seal the entry points completely with silicon to prevent water from entering the product. Failure to do this may render the product unusable or defective.

Class 2 Compliance When cutting your LUXNEON RGB tube, keep in mind that Class 2 compliance restricts the max load of the product to 96W, which in turn prevents the maximum cut length from exceeding 18ft (5.5m).

Avoid Electrical Shock Always disconnect the power supplies before installing or servicing to avoid electrical shock.

Actual Product Color May Vary Please note that the product color as seen in this specification sheet, photography, and related marketing material for this product may vary slightly from your actual customized product due to photographic and design limitations.

Specifications are Subject to Change Without Notice While we try to make every effort to inform customers of updates to our products, we reserve the right to make modifications and improvements to our fixture specifications and designs without advance notice.

Manufacturer is Not Liable for Matching Fixtures to Pre-Existing Fixture Installations We cannot guarantee matching the CCT appearance, product design, or lumen output for pre-installed fixtures or reorders.

LATERAL SIDE BENDING

LUXNEON™ easily bends laterally from left to right.



GOOD

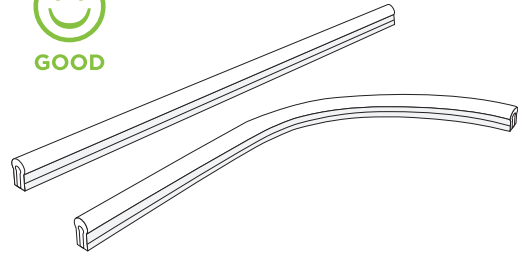

CONVEX TOP BENDING

Never attempt a convex bend with this product!*



BAD

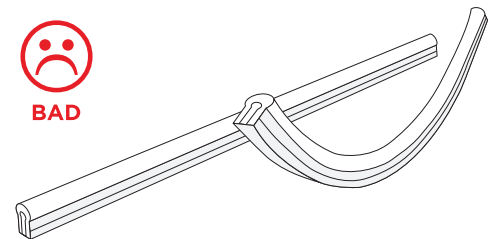

*But we do offer a lighting solution designed for convex bending that is similar to the LUXNEON™ Lateral "S" Flex. If interested, please reach out to one of our sales representatives for more information.

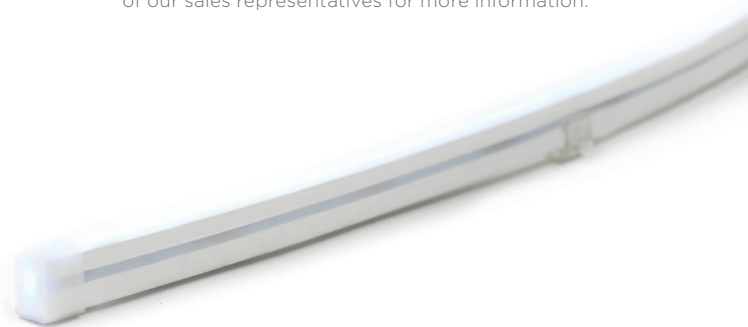

PROJECT NAME/NO.	PART NUMBER
SPECIFIED BY	NOTE

LUXNEON™



SIDE BEND

Indoor/Outdoor Series

APPLICATIONS

- Outdoor/Indoor Decorative Lighting
- Cove Lighting
- Awning Lighting
- Wall Wash Lighting
- Architectural Lighting
- Entertainment Lighting
- Theater Lighting
- Curved Embedded Lighting
- Decorative Linear Lighting
- Channel Letters
- Signage
- Border Tubing
- Accent Lighting
- Compact, Space-Sensitive Applications
- Retail Applications
- ...And Many More!



LUXNEON™ RGB SILICONE FLEX PART NUMBER

EXAMPLE

	LUXNEON™ RGB	24"	RGB	FROSTED SILICONE	4-PIN
NSS24ZAP	NSS	24	T	A	P
	PRODUCT LINE	LENGTH	COLOR	DIFFUSED OPTION	CONNECTOR
BUILD IT!					

PRODUCT LINE

NSS LUXNEON™ RGB SIDE BENDING

LENGTH (IN INCHES)

LL LENGTH (VARIES)

COLOR

T TRICOLOR (RGB)

DIFFUSED OPTION

A FROSTED SILICONE

CONNECTOR

M MOLEX®

H HARDWIRE

P 4-PIN

C SPECIAL

PROJECT NAME/NO.	PART NUMBER
SPECIFIED BY	NOTE